

Connecting device to display

Use the lectern PC to play your presentations. If you wish to use your own laptop, follow steps 1-4.

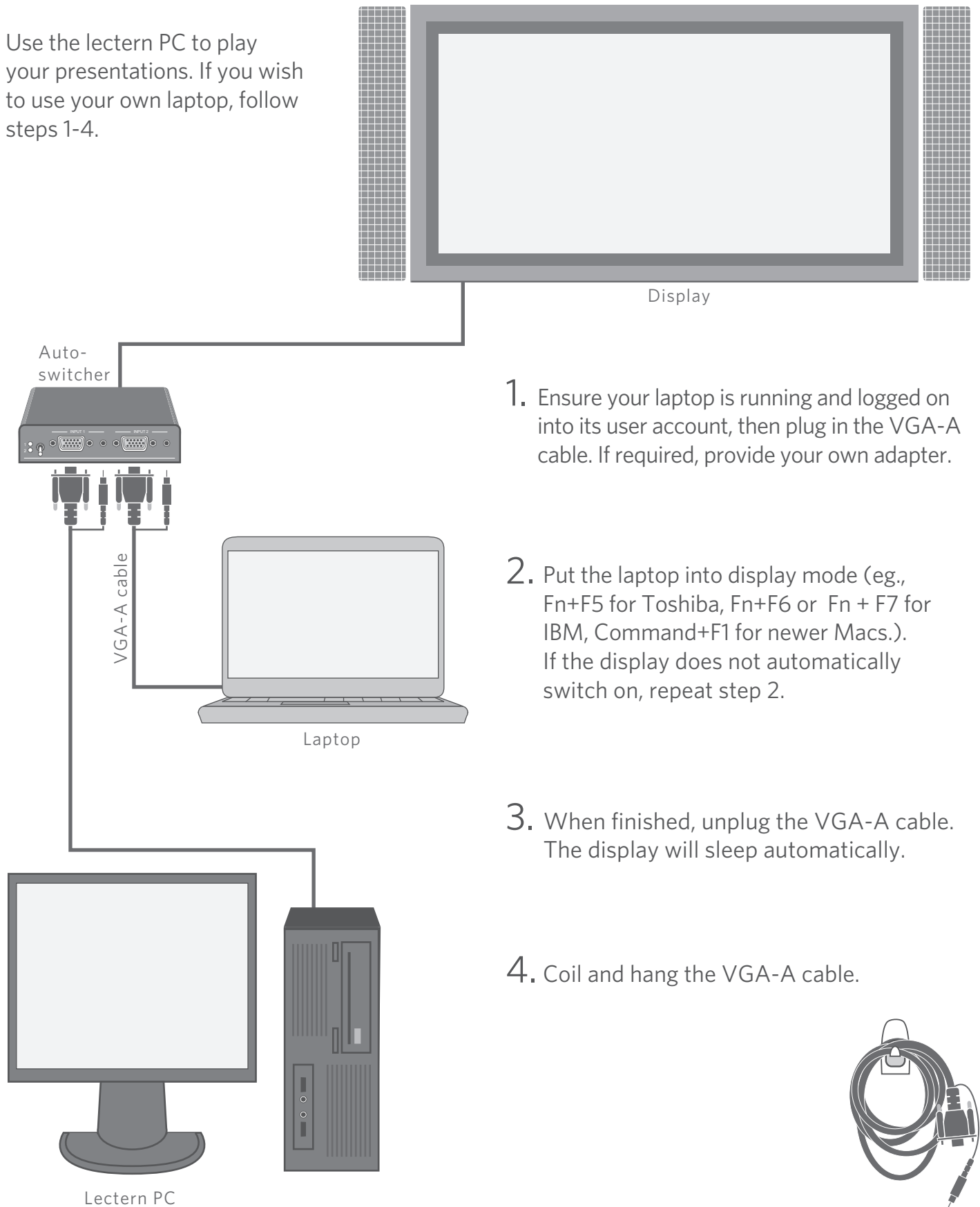

1. Ensure your laptop is running and logged on into its user account, then plug in the VGA-A cable. If required, provide your own adapter.
2. Put the laptop into display mode (eg., Fn+F5 for Toshiba, Fn+F6 or Fn + F7 for IBM, Command+F1 for newer Macs.). If the display does not automatically switch on, repeat step 2.
3. When finished, unplug the VGA-A cable. The display will sleep automatically.
4. Coil and hang the VGA-A cable.

